

## BUILDING: AP HOUSE OF THE WEEK



### PLAN DD-1734 DESIGN DETAILS

**Bedrooms: 2+**  
**Baths: 2**  
**Main floor: 1,742 sq. ft.**  
**Total living area: 1,742 sq. ft.**  
**Standard basement: 1,742 sq. ft.**  
**Exterior wall framing: 2x4**  
**Foundation options: Crawl space, slab, standard basement**

A sidelighted entry is the focal point of the facade, which is enhanced by a railed front porch.

## The Great Outdoors

FOR AP WEEKLY FEATURES

With a full-sized porch up front and a covered patio to the rear of this home, Plan DD-1734, by Home Plans LLC, provides plenty of options for outdoor living! Its floor plan covers 1,742 square feet of living space.

Just steps away from the entry is the dining room, subtly outlined by decorative columns. A fireplace anchors the adjoining living room, which looks out to a rear patio.

The galley kitchen offers a pantry for extra storage and a handy snack bar servicing the bayed morning room, which accesses the patio.

Tucked away is the master suite. A boxed-out window illuminates the room, while the private bath—complete with a pair of sinks, two walk-in closets, a tub and a separate shower—is the picture of luxury.

A secondary bedroom occupies the other side of the home and shares a full bath with a third bedroom or optional study. The nearby utility room accesses the outdoors.

### Order information

A downloadable study plan of this house, including general information on building costs and financing, is available at [www.houseoftheweek.com](http://www.houseoftheweek.com). To receive a study plan by mail, send \$10 to House of the Week, P.O. Box 75488, St. Paul, MN 55175-0488, or call (866) 772-1013. Be sure to reference the plan number. To view hundreds of home designs, visit our Web site at [www.houseoftheweek.com](http://www.houseoftheweek.com).

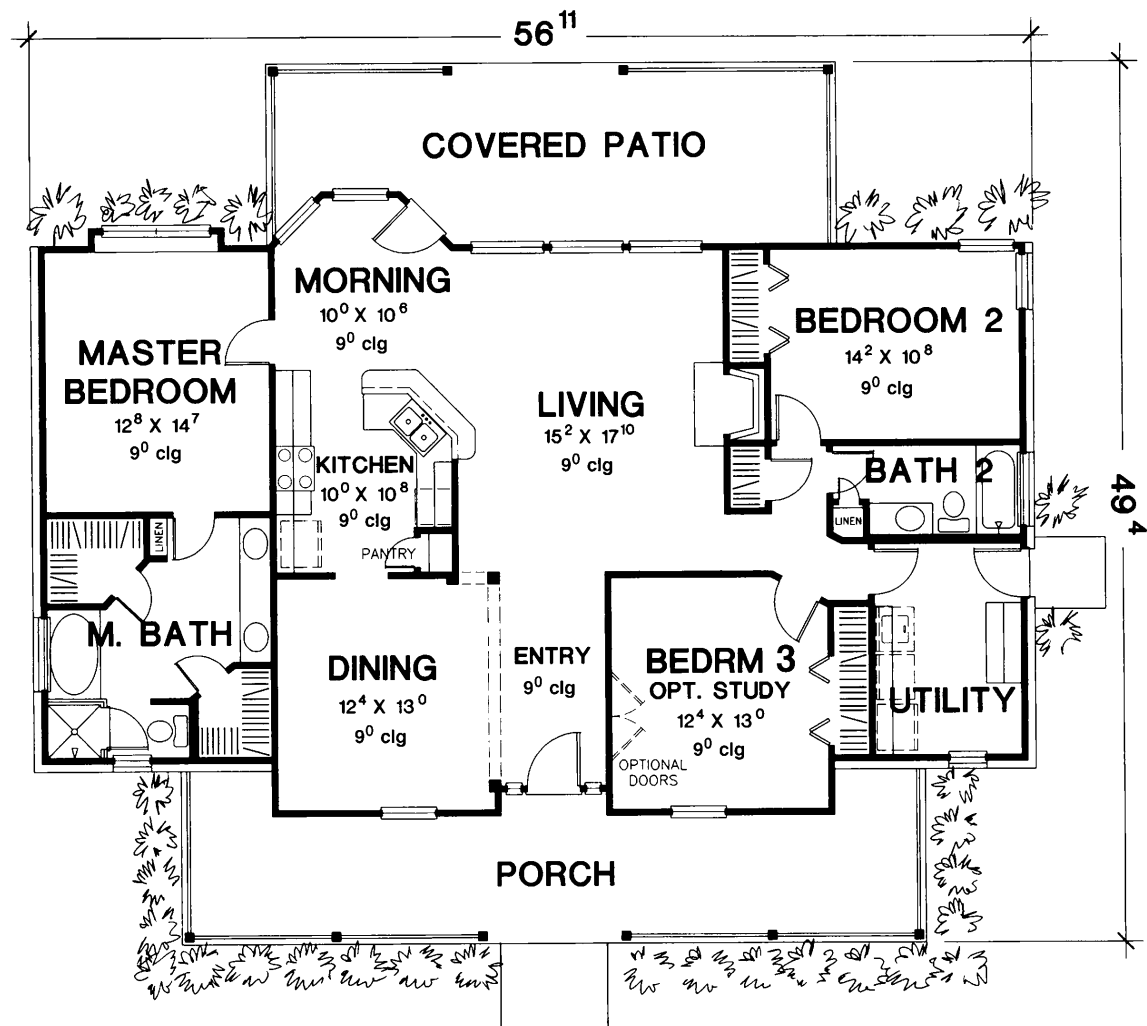

An open layout floor plan with a split-bedroom design provides plenty of space for living and privacy, too. A front porch and back patio offer options for outdoor living.